

GENERAL SITE NOTES

1. GENERAL CONTRACTOR TO CONFIRM THE LOCATION OF ALL EXISTING UTILITIES PRIOR TO ANY CONSTRUCTION OF PROPOSED IMPROVEMENTS.
2. NO CONSTRUCTION/FIELD CHANGES WITHOUT THE APPROVAL OF THE CONSULTING ENGINEER, OWNER, AND CITY OF GALAX.
3. G.C. TO ENSURE POSITIVE DRAINAGE AWAY FROM ALL BUILDINGS.
4. G.C. SHALL OBTAIN A RIGHT OF WAY PERMIT FROM VDOT PRIOR TO ANY WORK WITHIN THE VDOT RIGHT OF WAY.
5. ANY PAVEMENT DISTURBED OR DESTROYED DURING THE CONSTRUCTION PROCESS SHALL BE REPAIRED/REPLACED AS NECESSARY TO PRE-CONSTRUCTION CONDITIONS AT NO COST TO THE OWNER.
6. ALL BUILDING DIMENSIONS SHALL BE COORDINATED WITH THE ARCHITECTURAL PLANS.
7. PAVEMENT FLOW LINE RADIUS OF 5' IS TYPICAL.
8. ASPHALT SURFACES SHALL HAVE A MINIMUM SLOPE OF 2% AND CONCRETE SURFACES SHALL HAVE A MINIMUM SLOPE OF 1% UNLESS OTHERWISE NOTED ON PLANS.
9. ALL ROOF DRAINS SHALL DISCHARGE TO THE PROPOSED DETENTION BASIN.

UTILITY NOTES

1. G.C. SHALL COORDINATE THE EXACT SANITARY SEWER AND DOMESTIC WATER LATERAL BUILDING TIE IN LOCATIONS WITH THE ARCHITECTURAL PLANS.
2. ALL UTILITY SERVICE LATERALS OR LINES, INCLUDING ELECTRIC, SHALL BE INSTALLED UNDERGROUND. WATER & SEWER CONNECTIONS SHALL CONFORM TO THE CITY OF GALAX UTILITY STANDARDS AND INTERNATIONAL BUILDING CODE.
3. THE G.C. SHALL COORDINATE TEMPORARY POWER FOR THE PROPOSED BUILDINGS.
4. THE G.C. IS RESPONSIBLE FOR PROVIDING AND INSTALLING ALL CONDUIT ASSOCIATED WITH REQUIRED UTILITIES FOR THE PROPOSED BUILDING AND ANY NECESSARY UTILITIES ON-SITE SUCH AS LIGHTING, ELECTRICAL, ETC.
5. SEE ARCH/MEP DRAWINGS FOR INFORMATION CONCERNING SPRINKLER REQUIREMENTS AND ADDITIONAL BUILDING DETAILS.
6. SANITARY WASTE LINES FROM BUILDING SHALL BE A MINIMUM 4" PVC (MIN. SLOPE 2.08%)

PARKING LOT STRIPING NOTES:

1. ALL PARKING SPACE STRIPING WILL BE WHITE.
2. HANDICAPPED SPACES AND HATCHED AREAS WILL BE YELLOW.
3. HANDICAPPED SYMBOL  WILL BE BLUE.

LEGEND

- (C) CONCRETE SIDEWALK
- (B) BUMPER BLOCK
- (D) VDOT STOP SIGN
- (H) HANDICAP PARKING & SIGN
- (M) METER WATER 3/4" CITY OF GALAX UTILITY CONTR. EXISTING BEYOND W.M. BY PLUMB.
- (P) CONNECTION BY PLUMBER
- (S) SEWER LATERAL 4" UTILITY CONTR. EXISTING
- (CG) SEWER CLEANOUT
- (W) WATER LATERAL 1" CITY OF GALAX UTILITY CONTR. EXISTING

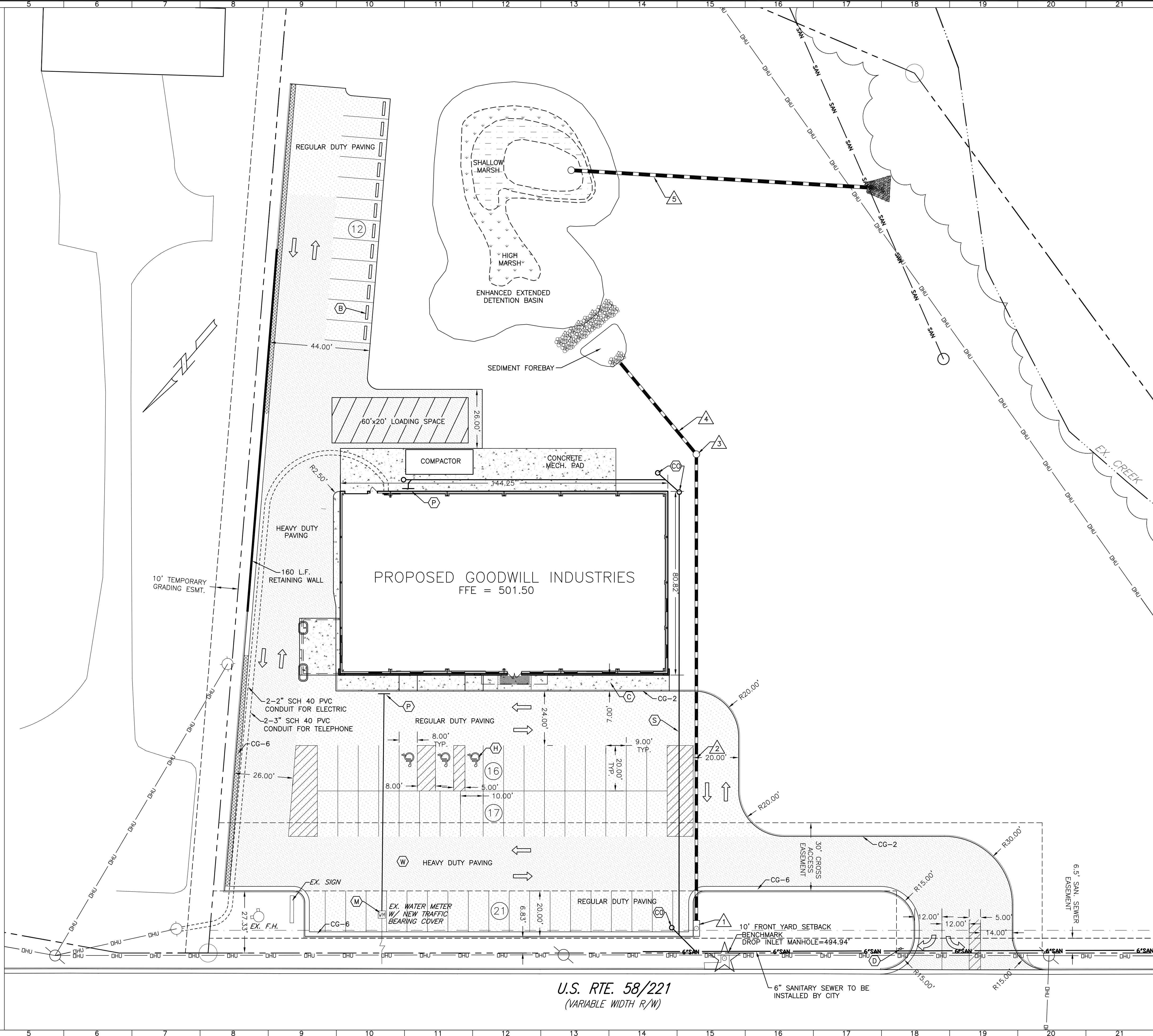

U.S. RTE. 58/221
(VARIABLE WIDTH R/W)